

Technical Specs:

Insulator: Black glass filled polyester
Flammability: PPS-GF30-FR
 UL 94V-0
Sleeve: Brass
Contact clip(4 finger): Beryllium copper(C17200)
 Ø0.40 to 0.56mm
Accepted pin: (polished steel gauge Ø0.43mm)
 Forces:
 -Insertion 2 N typ
 -Withdrawal 1 N typ
Mechanical life: min500 cycles
Rated current: 3A
Contact resistance: max 10mΩ
Dielectric resistance: Min 1000V RMS

Ordering Information

3612-28 2 XX R XX 121 01

No. of Pins 2x40Pin
 Contact Plating SN/Tin
 G0:Gold Flash
 G2:2U"Gold
 G3:3U"Gold
 G4:5U"Gold
 G5:10U"Gold
 S0:gold Flash/Tin
 Standard:G0
 Length 121=12.1mm

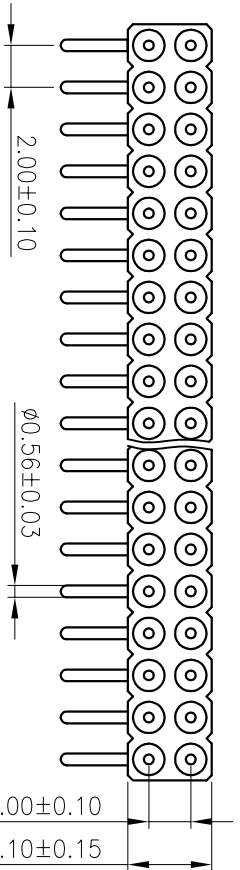

注: 整条总长+0.5

N X 2.00 ±0.30

(N - 1) X 2.00 ±0.30

Ø0.47±0.03

2.80±0.15

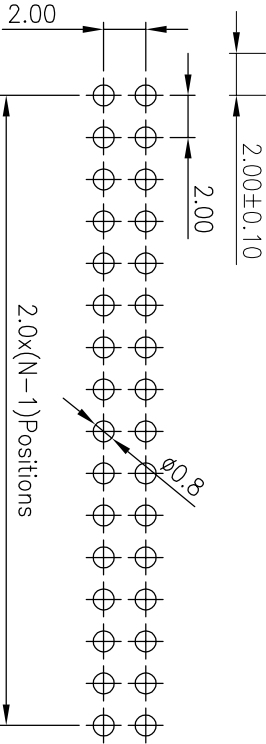
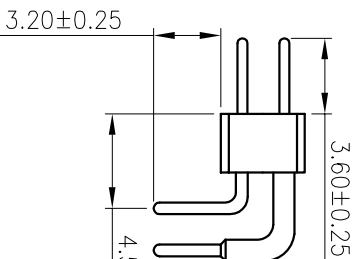

Recommended P.C.B Layout(Top Side)
(PCB BOARD TOLERANCE±0.05)

REV	DATE	MODIFICATION DESCRIPTION	CHANGE	OPERATION		DRAW	yiyusheng	18.12.13	SCALE	FIT	PART NO.	TITLE:
				X.X	±0.30				UNIT	mm		
A0	2018.12.13	NEW DRAWING		X.XX	±0.20	CHECK		SIZE	A4		3612282XXRXX12101	
				X:XXX	±0.10			SHEET	1.5/1			
				Angle	±3°	APPROVE		PROJ.				
				DIM	TOL							

BESTCONN(WUHAN) TECHNOLOGY CO.,LTD
<https://bscconnector.com/>

2.0X2.8 双头针 90° Dual Row
L=12.1/16.1mm