

HSE ROHS

SPECIFICATIONS

Rated Current: 7.0AMP
 Contact Resistance: 20mΩ Max
 Withstand Voltage: 1000V AC/DC
 Insulation Resistance: 1000MΩ Min
 Operation Temperature: -40°C to +105°C

Contact Material: Brass
 Contact Plating: Sn Over Ni
 Insulator Material: Polyester (UL94V-0)
 Standard: LCP
 Max. Processing Temp: 230°C for 30-60 seconds
 (260°C for 5 seconds)

Recommended P.C.B Layout (Top Side)
 (PCB BOARD TOLERANCE ±0.05)

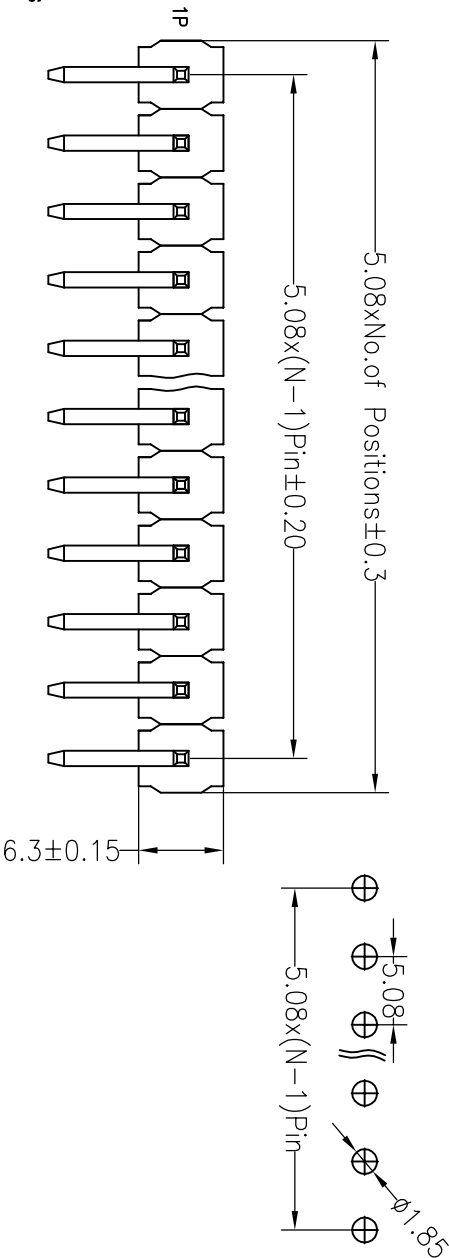

Ordering Information

1125 11XX F N XX R XXX X 01

No. of Pins Per Row 1x20
 Insulator Material Option
 A=BK-PBT
 B=BK-PA66
 C=BK-PA6T
 D=BK-PA46
 E=BK-PA9T
 F=BK-LCP
 Contact Plating
 G0:Gold Flash
 S0:Gold Flash/Tin
 SN:Tin
 SM:Matte-Tin
 Pin Length
 Packing
 0=PTE Bag
 A=Tray
 T=Tube

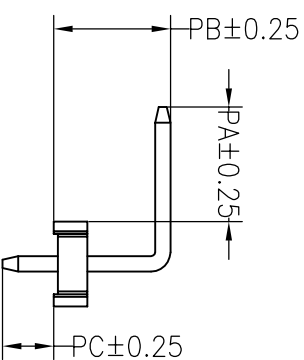
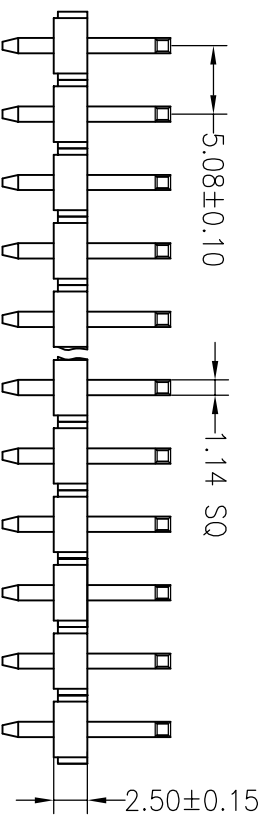

Dimension antitheses list				
ITEM	PA	PB	PC	L
Standard	8.00	5.00	3.50	18.8
Alternate				

BESTCONN(WUHAN) TECHNOLOGY CO.,LTD
<https://bsconnector.com/>

REV	DATE	MODIFICATION DESCRIPTION	CHANGE	DIM	TOL	APPROVE	PROJ.	TITLE:
A0	2012.04.11	NEW DRAWING		X:XXX	±0.10	CHECK		PART NO. 112511XXXFNXXXXXX01
1			4	Angle	±3°	APPROVE		5.08PH 1xNpin H2.5mm 90°

OPERATION		DRAW		SCALE		FIT		BESTCONN(WUHAN) TECHNOLOGY CO.,LTD	
			Ben	UNIT	mm	UNIT	mm	https://bsconnector.com/	
X.X	±0.30			SIZE	A4			PART NO. 112511XXXFNXXXXXX01	
X.XX	±0.20			SHEET	1/1			TITLE: 5.08PH 1xNpin H2.5mm 90°	
X:XXX	±0.10			PROJ.					