

SPECIFICATIONS

Rated Current:1.5AMP
 Contact Resistance:20mΩ Max
 Withstand Voltage:500V AC/DC
 Insulation Resistance:800MΩ Min
 Operation Temperature:-40°c to +105°c
 Contact Material:Brass
 Contact Plating:Au or Sn Over Ni
 Insulator Material:Polyester(UL94V-0)
 Standard: PA6T
 Max.Processing Temp: 230°C for 30-60 seconds
 (260°C for 10 seconds)

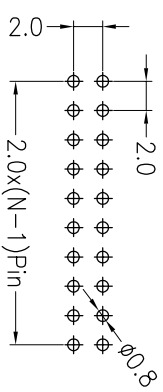
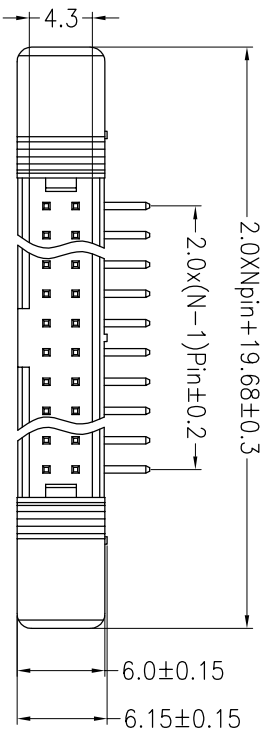

Recommended P.C.B Layout(Top Side)
 (PCB BOARD TOLERANCE±0.05)

Ordering Information

3320 XX R XX X X L X 0X

No. of Pins 6--64
 Contact Plating G0:Gold Flash G1:1U" Gold G2:1.5U" Gold G3:2U" Gold G4:3U" Gold G5:5U" Gold S0:Gold Flash/Tin
 Insulator Material Option A=BK-PBT C=BK-PA6T D=BK-PA46 E=BK-PA9T F=BK-LCP
 Color Type B=Black G=Grey
 Latch Type L=Long Latch A=Triw T=Tube
 Pinning Bag 0=PE A=Tray

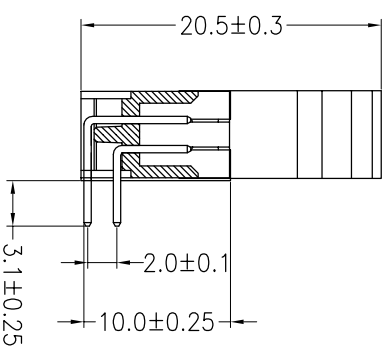
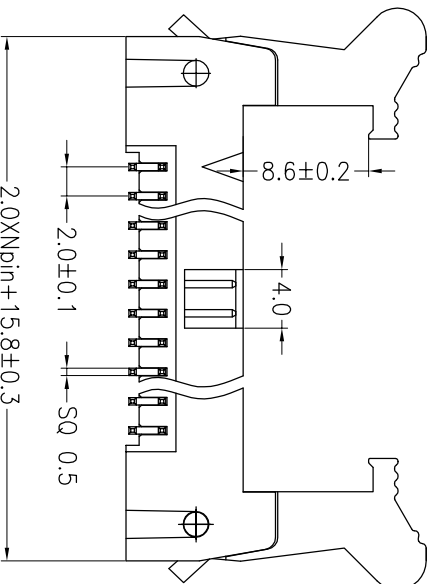

OPERATION		DRAW		SCALE	FIT	BESTCONN(WUHAN) TECHNOLOGY CO.,LTD		
X.X		Y.YuSheng		UNIT	mm	https://bsconnector.com/		
X.XX		CHECK		SIZE	A4	PART NO. 3320XXXXXXLX0X		
X.XXX		±0.10		SHEET	1/1	TITLE: 2.0 ejector header Npin 90° 长耳		
±3°		APPROVE		PROJ.				
CHANGE		DIM		TOL				
REV	DATE	MODIFICATION DESCRIPTION						
A0	2019.10.05	NEW DRAWING						
1								