

**Masterials**  
Pin: Brass, machined, (H59-3)  
Plating: Gold plated: 1.25u"m/50u"nickel, full gold  
Insulator body (black): PPS( UL94V-0)

**Electrical**  
Current rating: 2Amps/contact max.  
Contact resistance: 20mΩ  
Insulation resistance: 1000MΩ  
Operating voltage: 60 AC/DC

**Mechanical**  
Operating temperature : Gold plated: -55°C to +105°C  
(Continuous) -67"H to +105"H  
Tin plated: -40°C to +105°C  
Soldering temperature: 260°C, 10s max

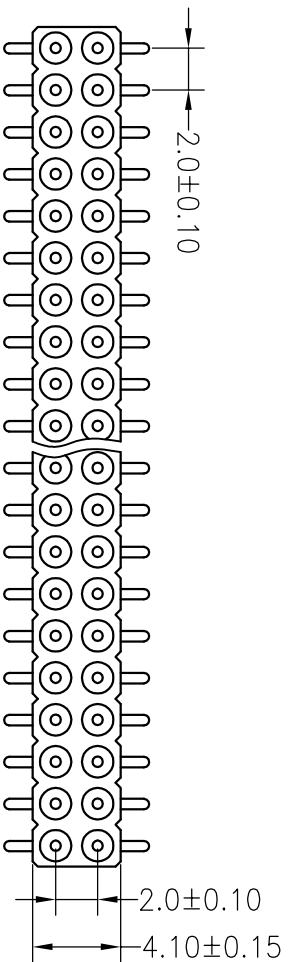

注: 整条总长+0.5

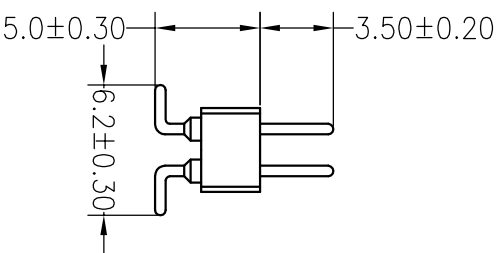
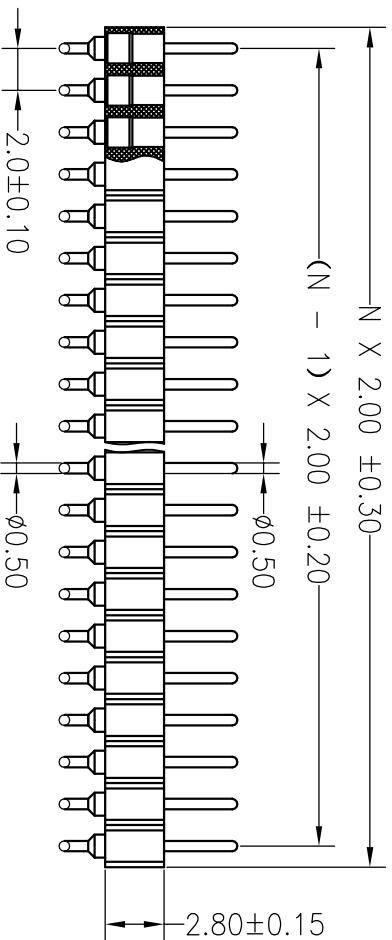

## Ordering Information

3612-28 2 XX M XX 100 01

No. of Rows  
1=Single Row  
2=Dual Row

No. of Pins  
2x40Pin

Contact Plating  
SN: Tin  
G1: 1U"Gold  
G2: 1.5U"Gold  
G3: 2U"Gold  
G4: 3U"Gold  
G5: 5U"Gold  
S0: Gold Flash/Tin

Length  
100=10.0mm

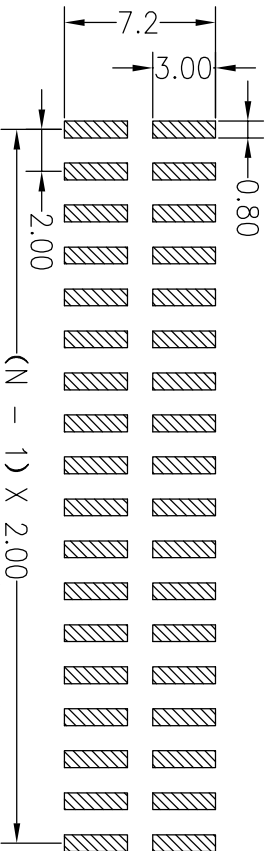

Recommended P.C.B Layout(Top Side)  
(PCB BOARD TOLERANCE±0.05)

OPERATION		DRAW		SCALE		FIT		BESTCONN(WUHAN) TECHNOLOGY CO.,LTD	
X.X	±0.30	yiyusheng	18.12.13	UNIT	mm	A4		https://bsconnector.com/	
X.XX	±0.20	CHECK		SIZE				PART NO. 3612282XXMXX10001	
X:XXX	±0.10	APPROVE		SHEET	1.5/1			2.0x2.8双头针 180°L=10.0(针尖0.5-0.5)	
Angle	±3°	PROL.		TITLE:					
DIM	TOL	CHANGE		DATE		MODIFICATION DESCRIPTION			
REV	DATE	NEW DRAWING		2018.12.13		A0			