

Technical Specs:

Insulator: Black glass filled polyester PPS-GF30-FR

Flammability: UL 94V-0

Sleeve: Brass

Accepted pin: $\varnothing 0.41$ mm

Mechanical life: min 500 cycles

Rated current: 1A

Dielectric resistance: Min 1000V RMS

Coplanarity SMD

terminations: max 0.1 mm (measured on 25 mm

long connectors)

注明:带号码球的为检验尺寸,带▲为重要检验尺寸

Ordering Information

3614 22 1 XX S XX 081 02

Plastics Height
16=1.6mm
22=2.2mm

No. of Pins Per Row
1X50

Contact Plating
SN: Tin
G0: Gold Flash
G2: 2U"Gold
G3: 3U"Gold
G4: 5U"Gold
G5: 10U"Gold

Pin Length
081=8.1mm

S0: Gold Flash/Tin
Standard: G0

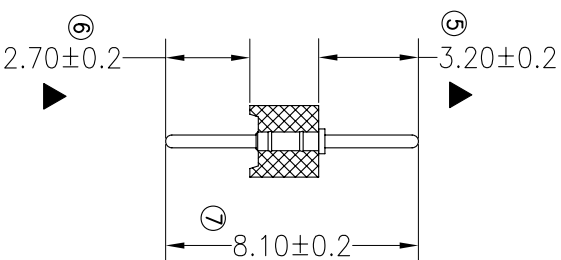
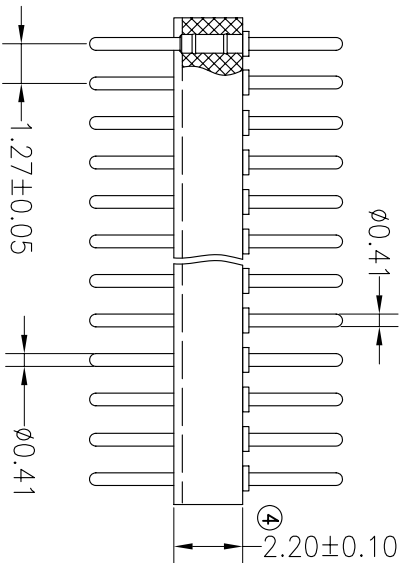
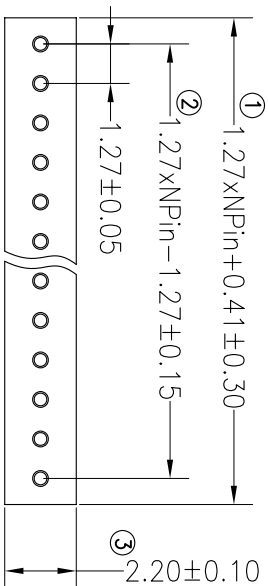

OPERATION		DRAW		SCALE		FIT		TITLE:	
X.X	±0.30	Y/YuSheng	12.07.23	UNIT	mm	SIZE	A4	PART NO.	3614221XXSX08102
X.XX	±0.20	CHECK		SHEET	1/1	TITLE:			
X.XXX	±0.10	APPROVE		PROJ.					
Angle	±3°								
DIM	TOL								
REV	DATE	MODIFICATION DESCRIPTION	CHANGE						
A0	2012.07.23	NEW DRAWING							
1									

BESTCONN(WUHAN) TECHNOLOGY CO.,LTD									
https://bscconnector.com/									
PART NO. 3614221XXSX08102									
TITLE: 1.27mm单排双头针座 针长L=8, 10 正向									