

Technical Specs:

Insulator: Black glass filled polyester PPS-GF30-FR
 Flammability: UL 94V-0
 Sleeve: Brass
 Accepted pin: Ø0.41 mm
 Mechanical life: min500 cycles
 Rated current: 1A
 Dielectric resistance: Min 1000V RMS
 Coplanarity SMD
 terminations: max 0.1 mm(measured on 25 mm long connectors)

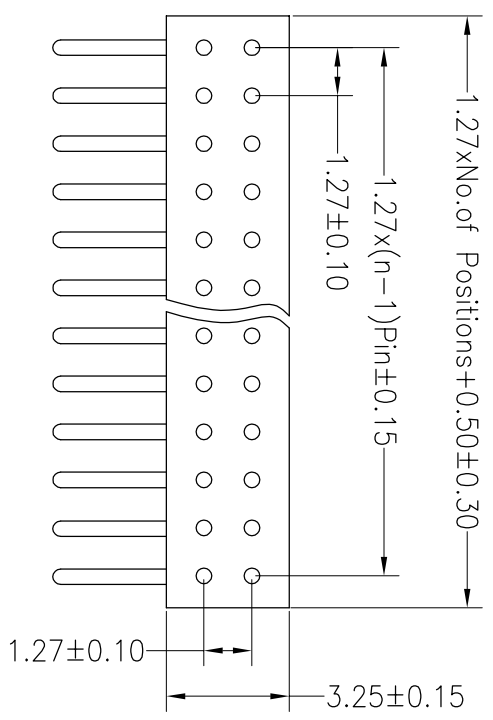

Recommended P.C.B Layout(Top Side)
 (PCB BOARD TOLERANCE±0.05)

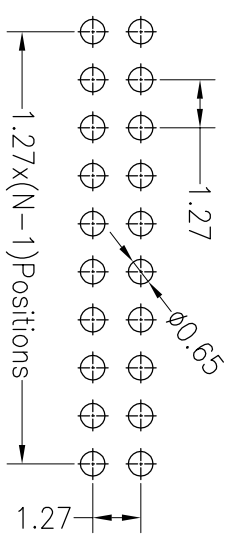

Ordering Information

3614 19 2 XX R XX 101 01

Plastics Height 19=1.9mm
 No. of Pins 2*1~2*50
 Contact Plating SN:Tin
 G0:Gold Flash
 G2:2U"Gold
 G3:3U"Gold
 G4:5U"Gold
 G5:10U"Gold
 S0:Gold Flash/Tin
 Pin Length 101=10.1mm

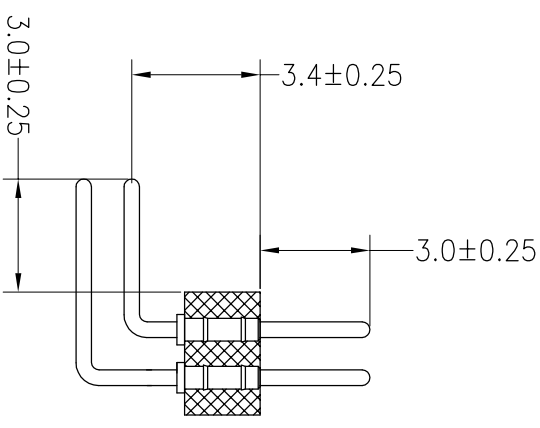
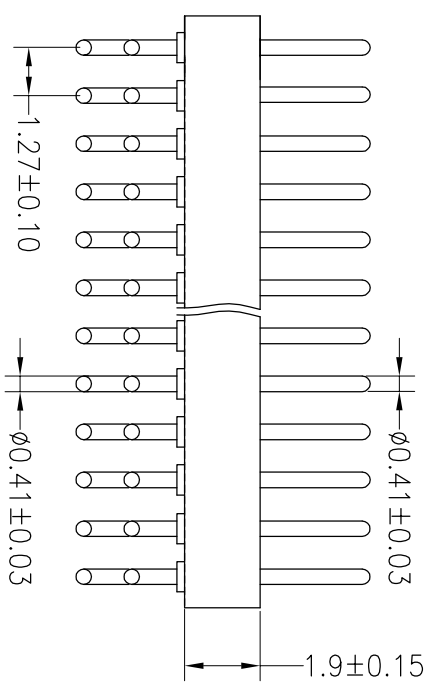

OPERATION		DRAW		SCALE		FIT		BESTCONN(WUHAN) TECHNOLOGY CO.,LTD	
X.X	±0.30	Y.YuSheng	21.03.11	UNIT	mm	A4	1/1	https://bsconnector.com/	
X.XX	±0.20	CHECK		SIZE	A4	PART NO.		3614192XXRXX10101	
X.XXX	±0.10	APPROVE		SHEET	1/1	TITLE:		1.27X1.9 Machine Pin Header 90°	
Angle	±3°	CHANGE		PROJ.		L=10.1/12.6mm			
DIM	TOL	DIM		TOL		DATE		2021.03.11	
MODIFICATION DESCRIPTION		DATE		NEW DRAWING		REV		A0	
1		2		3		4		5	