

# HSE ROHS

## SPECIFICATIONS PERFORMANCE

Electrical Rating: AC/DC 50V 0.5A  
 Insulation Resistance: 500MΩ  
 Withstang Volt: 200V AC/minute  
 Oprating Temperature: -40<sup>o</sup>t+105<sup>o</sup>.  
 Material  
 Contact: Phosphor Bronze Gold-Plated  
 Housing: LCP

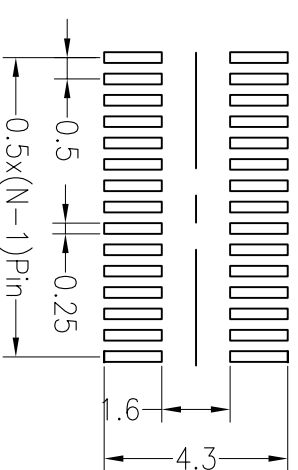
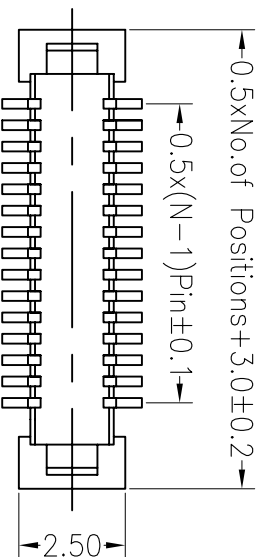

Recommended P.C.B Layout(Top Side)  
 (PCB BOARD TOLERANCE±0.05)

## Ordering Information

3720-M XXX 012 XX F X 02

F=Female  
 M=Male  
 No.of pins 20~100P  
 Plastic Height 012=1.25mm  
 Contact Plating G0:Gold Flash  
 G2:5U" Gold  
 G3:10U" Gold  
 G4:15U" Gold  
 G5:30U" Gold  
 S0:Gold Flash/Tin  
 Packing T:Tube  
 R:Reel

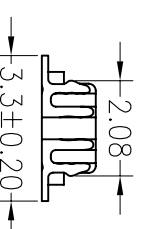
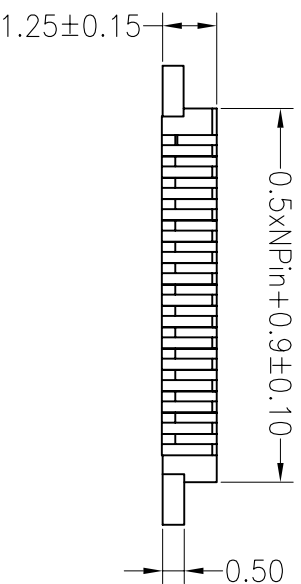

OPERATION		DRAW		YTYuSheng		12.03.28		SCALE		FIT		BESTCONN(WUHAN) TECHNOLOGY CO.,LTD <a href="https://bsconnector.com/">https://bsconnector.com/</a>	
X.X		±0.30		X.XX		±0.20		UNIT		mm			
X.XXX		±0.10		X.XXX		±0.10		SIZE		A4			
Angle		±3°		APPROVE		SHEET		1/1		PROJ.		PART NO. 3720-MXXX012XXFX02	
DIM		TOL		CHANGE		MODIFICATION DESCRIPTION		DATE		REV		TITLE: 0.5BTB NPin H1.25 Male	
1		2		3		4		5		6		7	
A		B		C		D		E		F		G	