

Technical Specs:

Insulator: Black glass filled polyester PBT
Flammability: UL 94V-0
Sleeve: Brass
Contact clip(4/6 finger): Beryllium copper(C17200)
Accepted pin: Ø0.40 to 0.56mm
Forces: (polished steel gauge Ø0.43mm)
 --Insertion 2 N typ
 1 N typ
 --Withdrawal min100 cycles
Mechanical life: 1A
Rated current: max 10mA
Contact resistance: Min 1000MΩ
Dielectric resistance: Min 1000MΩ
Operation Temperature: -40°C to +105°C

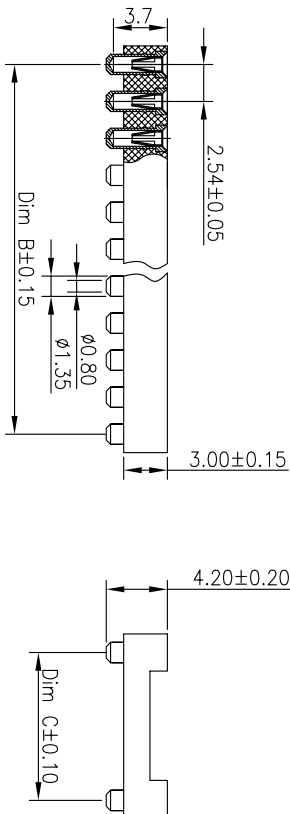

Ordering Information

7210 30 X XX S XX 042 X1

N=7,62PH No. of Pins
 E=10,16PH 4~64Pins
 W=15,24PH
 Connector Type
 G0=Gold Flash
 S0=Gold
 S3=10u" Gold/Tin
 S4=15u" Gold/Tin
 S5=30u" Gold/Tin
 Pin Length
 042=4,20mm
 Packing
 0=Pe Bag
 1=Tube

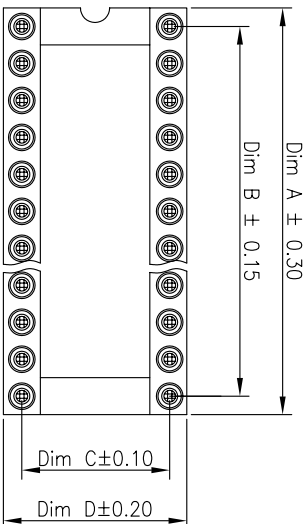

Contact	Dim A	Dim B	Dim C	Dim D
4	5.08	2.54	7.62	10.16
6	7.62	5.08	7.62	10.16
8	10.16	7.62	7.62	10.16
10	12.70	10.16	7.62	10.16
14	17.78	15.24	7.62	10.16
16	20.32	17.78	7.62	10.16
18	22.86	20.32	7.62	10.16
20	25.40	22.86	7.62	10.16
24	30.48	27.94	7.62	10.16
28	35.56	33.02	7.62	10.16
16	20.32	17.78	10.16	12.70
20	25.40	22.86	10.16	12.70
22	27.94	25.40	10.16	12.70
24	30.48	27.94	10.16	12.70
28	35.56	33.02	10.16	12.70
28	35.56	33.02	15.24	17.78
32	40.64	38.10	15.24	17.78
36	45.72	43.18	15.24	17.78
40	50.80	48.26	15.24	17.78
42	53.34	50.80	15.24	17.78
48	60.96	58.42	15.24	17.78
50	63.50	60.96	15.24	17.78
52	66.04	63.50	15.24	17.78
50	63.50	60.96	22.86	25.40
52	66.04	63.50	22.86	25.40
64	81.28	78.74	22.86	25.40

BESTCONN(WUHAN) TECHNOLOGY CO.,LTD
<https://bsconnector.com/>

OPERATION	DRAW	Ben	14.04.01	SCALE	FIT	PART NO.
X.X	±0.30			UNIT	mm	721030XXXXXX042X1
X.XX	±0.20			SIZE	A4	
X.XXX	±0.10			SHEET	1/1	
Angle	±3°			PROJ.		
DIM	TOL					
DATE	MODIFICATION DESCRIPTION	CHANGE				TITLE:
2014.04.01	NEW DRAWING					2.54x3.0 Machine Pin 1C Socket/L=4.20mm
REV						